

County Surveyor's Office
Stanislaus County, Cal.

Swamp and Overflowed Lands.

Survey No 138

Township 4 South

Range 18 & 19 East

Sections 18 & 19, all between the United States meander line & the left bank of the Tuolumne River in section 19, and ~~xxx~~ in the South West $\frac{1}{4}$ of the South East $\frac{1}{4}$, a fractional part of the North West $\frac{1}{4}$ of the South East $\frac{1}{4}$ & the East $\frac{1}{2}$ of the South East $\frac{1}{4}$ of Section 18 Township 4 South Range 8 East

(a)

Base and meridian of Mount Diablo. Containing 80.51 Acres.

Surveyed July 20th 1860 for -

Stephen Thomas

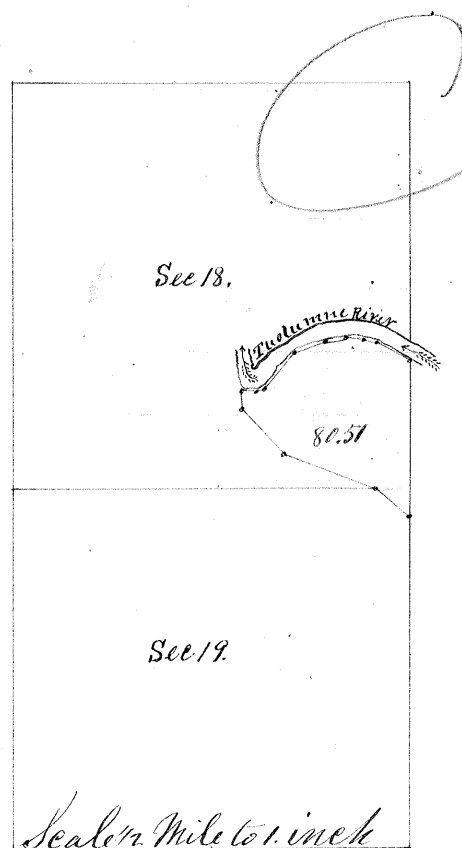

Field Notes:

Beginning at meander post on section line between sections 19 & 20, thence run on section line $N 1/2^\circ W$ 32.60 ch to the left bank of the Tuolumne River meander down stream, run $N 63^\circ W$ 8.00 ch $N 79^\circ W$ 3.00 ch $N 81 1/2^\circ W$ 3.41 ch $S 73 1/2^\circ W$ 4.67 ch $S 69 1/4^\circ W$ 7.00 ch $S 40^\circ W$ 9.20 ch $S 60 1/2^\circ W$ 11.65 ch $N 88 3/4^\circ W$ 3.20 ch to the U.S. meander line, thence run on the U.S. meander line $S 7 1/2^\circ E$ 3.65 ch $S 21 5/8^\circ E$ 12.65 ch $S 68 1/2^\circ E$ 20.30 ch $S 51 1/2^\circ E$ 9.00 ch to the place of beginning.

The above survey was embraced in that of No 60 made for William Egan Stein August 22^d 1856.

Run by the true Meridian: Magnetic Variation $15 45'$ East

Surveyed in accordance with the act of the Legislature concerning Swamp and Overflowed Lands, approved April 18th 1859, and the instructions of the Surveyor General

Silas Wilcox
County Surveyor Stanislaus Co.

Approved March 5th 1860

H. A. Higley
Surveyor General

Recorded March 21st 1860

Silas Wilcox
County Surveyor