

CORNER RECORD

Document Number CR 5289

City of OAKLAND

County of ALAMEDA, California

Brief Legal Description BRASS DISC MONUMENT LOCATED WITHIN THE INTERSECTION OF PIEDMONT AVENUE AND JOHN STREET. (53/Q)

9

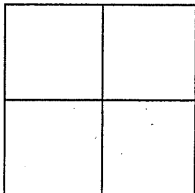

CORNER RECORD

COORDINATES  
(Optional)

Government Corner ☐ Control ☒  
Meander ☐ Property ☐  
Rancho ☐ Other ☐  
Date of Survey 10/19/12

N. \_\_\_\_\_  
E. \_\_\_\_\_  
Zone \_\_\_\_\_ Datum \_\_\_\_\_  
Elev. \_\_\_\_\_

Corner — Left as found ☒ Found and tagged ☐ Established ☐ Reestablished ☐ Rebuilt ☐

Identification and type of corner found: Evidence used to identify or procedure used to establish or reestablish the corner:  
FOUND BRASS DISC MONUMENT LOCATED WITHIN THE INTERSECTION OF PIEDMONT AVENUE AND JOHN STREET.

AS SHOWN ON CITY OF OAKLAND MONUMENT MAP, PAGE 287.

THIS POINT WAS REFERENCED PRIOR TO A CONSTRUCTION PROJECT IN THE VICINITY.

A description of the physical condition of the monument as found and as set or reset: \_\_\_\_\_

FOUND AND SET POINTS AS SHOWN ON PAGE 2.

THESE TIES ARE FOR THE PURPOSE OF PERPETUATING THE FOUND MONUMENTATION.

NO CLAIM IS MADE AS TO THE RELATIONSHIP OF THE POINTS OR LINES SHOWN HEREON TO TRUE BOUNDARY LOCATIONS.

SURVEYOR'S STATEMENT

This Corner Record was prepared by me or under my direction in conformance with

the Land Surveyors' Act on OCTOBER 25, 2012.

Signed Vincent H. Cunha L.S. Number LS 4520  
VINCENT H. CUNHA



COUNTY SURVEYOR'S STATEMENT

This Corner Record was received 12-28-2012 and examined

and filed 4-17-2013.

Signed Russell R. Penland Title COUNTY SURVEYOR

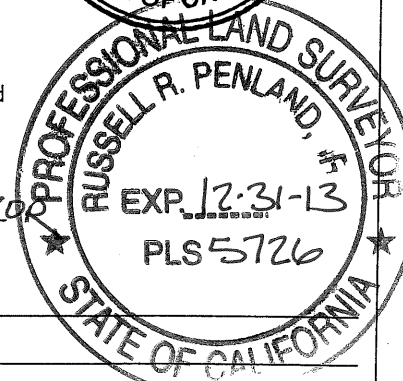

County Surveyor's Comment \_\_\_\_\_



SCALE: 1"=30'

## LEGEND

- FOUND BRASS DISC IN MONUMENT WELL ( $\frac{53}{Q}$ )
- ✕ SET CUT CROSS IN CONCRETE
- AA### ALAMEDA COUNTY MONUMENT ID

