

# CORNER RECORD

Agency Index

BK 136 PG 87

Document Number

CR 14525

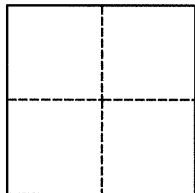
City of Oakland (APN 30-1980-44) County of Alameda, CaliforniaBrief Legal Description Monument near 3634 Quigley Street**CORNER TYPE****COORDINATES (Optional)**Government Corner ☐Control ☒Meander ☐Property ☐Rancho ☐Other ☐Date of Survey July 6, 2020

N. \_\_\_\_\_ E. \_\_\_\_\_

Elevation \_\_\_\_\_

Units \_\_\_\_\_

Metric ☐U.S. Survey Foot ☐

Horizontal Datum \_\_\_\_\_

Zone \_\_\_\_\_ Epoch Date \_\_\_\_\_

Vertical Datum \_\_\_\_\_

☐ Complies with Public Resources Code §§8801-8819☐ Complies with Public Resources Code §§8890-8902

PLS Act Ref.:

☐ 8765(d)☒ 8771☐ 8773☐ Other:Corner/  
Monument:☒ Left as found☐ Established☐ Rebuilt☒ Pre-Construction☐ Found and tagged☐ Reestablished☒ Referenced☐ Post-Construction

Narrative of corner identified and monument as found, set, reset, replaced, or removed:

☒ See sheet #2 for description(s):

Found monument that could be damaged or destroyed by planned water line construction project. Monuments were referenced as shown on page 2. The purpose of this Corner Record is to preserve possible evidence only; no attempt was made to determine the relationship to property, centerline, or right of way lines.

Reference EBMUD CR Book B, Page 20 (Taaning/Chou)

**SURVEYOR'S STATEMENT**

This Corner Record was prepared by me or under my direction in conformance with

the Professional Land Surveyors' Act on

Signed

P.L.S. or R.C.E. No.

8889

**COUNTY SURVEYOR'S STATEMENT**

This Corner Record was received

and examined and filed

NOV 05 2020

Signed

D. Ian Wilson

P.L.S. or R.C.E. No.

7010

Title ALAMEDA COUNTY SURVEYOR

County Surveyor's Comment

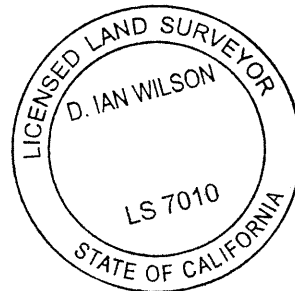

OAKLAND

ALAMEDA COUNTY

4 M 36  
BLOCK A3634 QUIGLEY STREET  
APN: 30-1980-44

QUIGLEY STREET

22 M 29  
BLOCK B

LOMA VISTA AVENUE

[100.33']  
2.3' SE'LY FROM JP  
30.30'[100.71']  
3' SW'LY FROM DI  
24.88'

[100.00']

[100.97']  
4.0' SW'LY  
FROM DI  
29.90'4 M 36  
BLOCK A[99.99']  
11.4' S'LY TO  
WATER VALVE  
46.39'LOCKE  
TRACT  
24 M 77  
BLOCK BSCALE  
1"=20'**LEGEND**

- ⊙ FOUND 3/8" PIN, NO WASHER, 1.0' DOWN IN MONUMENT WELL
- SET NAIL WITH 1-1/2" ALUMINUM WASHER STAMPED "EBMUD MON RP" IN TOP OF CURB
- [ ] ASSUMED ELEVATION (MEASURED USING A LEICA DNA10 DIGITAL LEVEL)
- + CUT CROSS ON MANHOLE RIM, 6.85' NE'LY TO MONUMENT

ADDRESS: 3634 QUIGLEY STREET

APN: 30-1980-44

