

CORNER RECORD

BK 55 PG 100

APN No. _____ (Optional)

Document Number _____ CR 1854

UNINCORPORATED

County of ALAMEDA, California

Brief Legal Description RAILROAD SPIKE ON 170TH AVE AT THE INTERSECTION OF ROGERIO ST

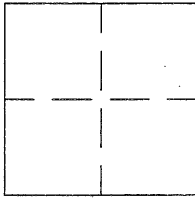

CORNER TYPE

Government Corner ☐ Control ☐
 Meander ☐ Property ☐
 Rancho ☐ Other ☒
 Date of Survey SEPT., 2002

COORDINATES (Optional)

N. _____
 E. _____
 Zone _____ Datum _____
 Elev. _____

Corner - Left as found ☐ Found and tagged ☐ Established ☒ Reestablished ☐ Rebuilt ☐

In compliance with Section 8771 of the Professional Land Surveyors' Act, this corner record is being filed to ESTABLISH X / REESTABLISH _____ the position of an existing monument PRIOR X / SUBSEQUENT _____ to street or highway reconstruction. (Use this portion only when applicable.)

Identification and type of corner found: Evidence used to identify or procedure used to establish or reestablish the corner:
THE CONTROL POINT DESCRIBED BELOW WAS REFERENCED BY AND SET CROSSES IN THE CONCRETE SIDEWALK.
SEE DRAWING NEXT PAGE.

A description of the physical condition of the monument as found and as set or reset: A RAILROAD SPIKE WAS FOUND IN GOOD CONDITION ON 170TH AVE. THIS CONTROL POINT IS IN DANGER OF BEING DESTROYED DUE TO ROAD CONSTRUCTION.

SURVEYOR'S STATEMENT

This Corner Record was prepared by me or under my direction in conformance with the Land Surveyors' Act on March 14, 2003.

Signed Gregory Donald Hollfelder L.S. or R.C.E. Number 5918



COUNTY SURVEYOR'S STATEMENT

This Corner Record was received 3-14-2003 and examined and filed 11-17-2013.

Signed Redmond Title County Surveyor



County Surveyor's Comment _____

REFERENCE: ALAMEDA COUNTY MAPS,

EL PORTAL, 12M73

A-926 SHEET 7

ALAMEDA COUNTY
Metric
UNITS ARE IN METERS
UNLESS OTHERWISE NOTED.

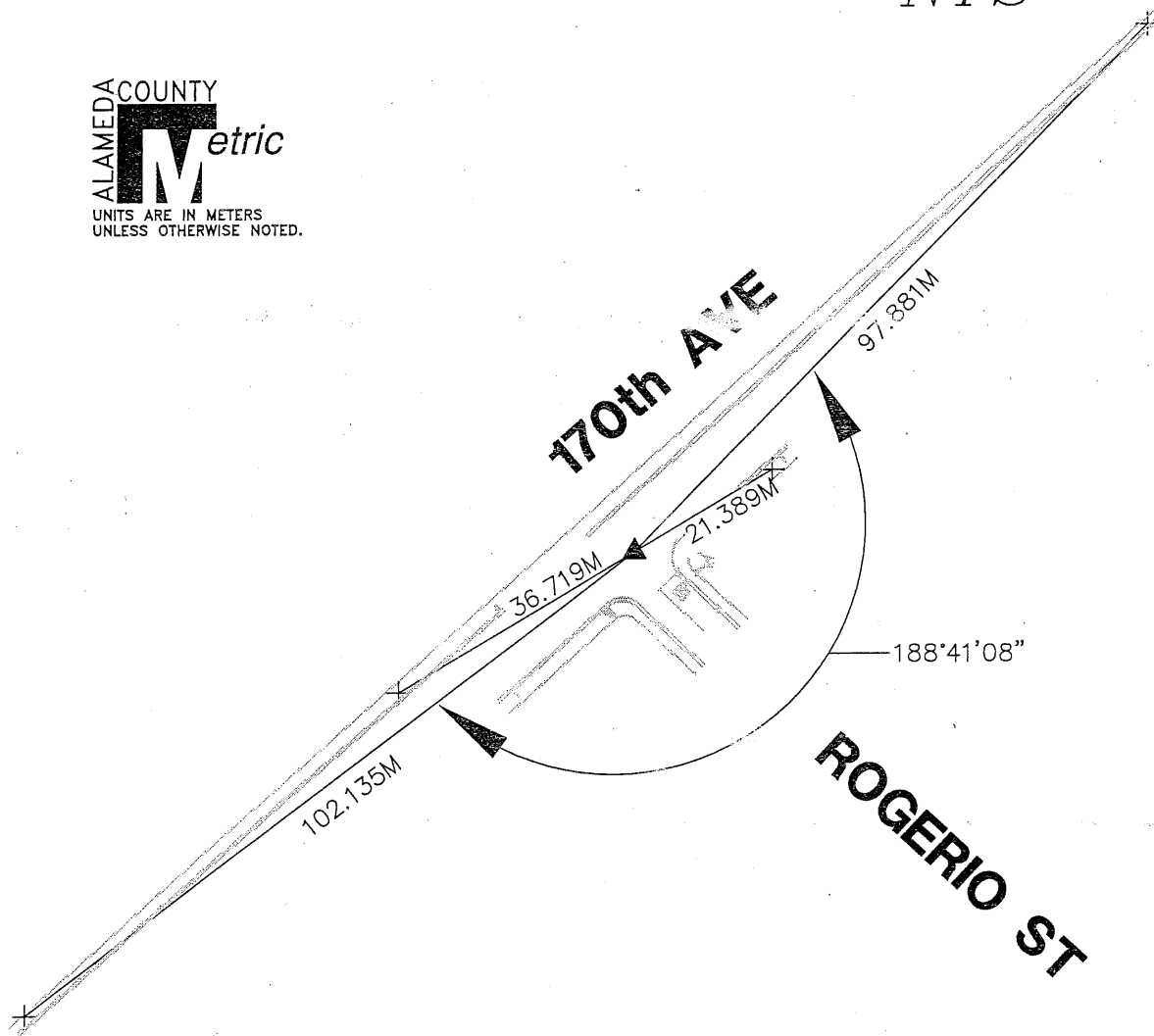
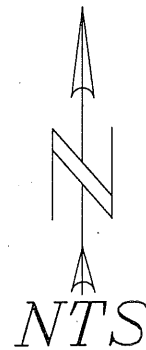

LEGEND:

▲ = FOUND RAILROAD SPIKE IN AC

+ = SET SCRIBED CROSS IN CONCRETE WALK IN LINE WITH RAILROAD SPIKE

M = METERS